



# Walk On Rooflight Fitting Guide



**01202 802111**

**[www.crlonline.co](http://www.crlonline.co)**

August 2024

If installing your walk on rooflight internally please contact us.  
Before installing your walk on rooflight **outside** YOU MUST carry out a water test prior to fitting.

The recommended gradient is 40mm for every 1000mm to run in accordance with the fall of your roof. A simple water test needs to be carried out and can be done by pouring water on the highest point of the walk on rooflight and look for any pooling as the water runs away.

You need to ensure the walk on rooflight is fitted with the correct fall if installing outside to allow water to run off the glazing.

**CRL take no responsibility for any water pooling after installation if set at the wrong height.**

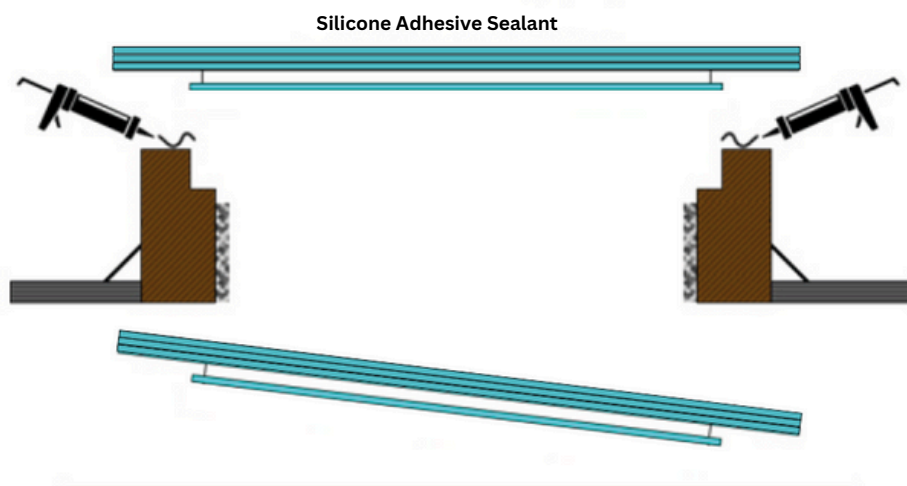
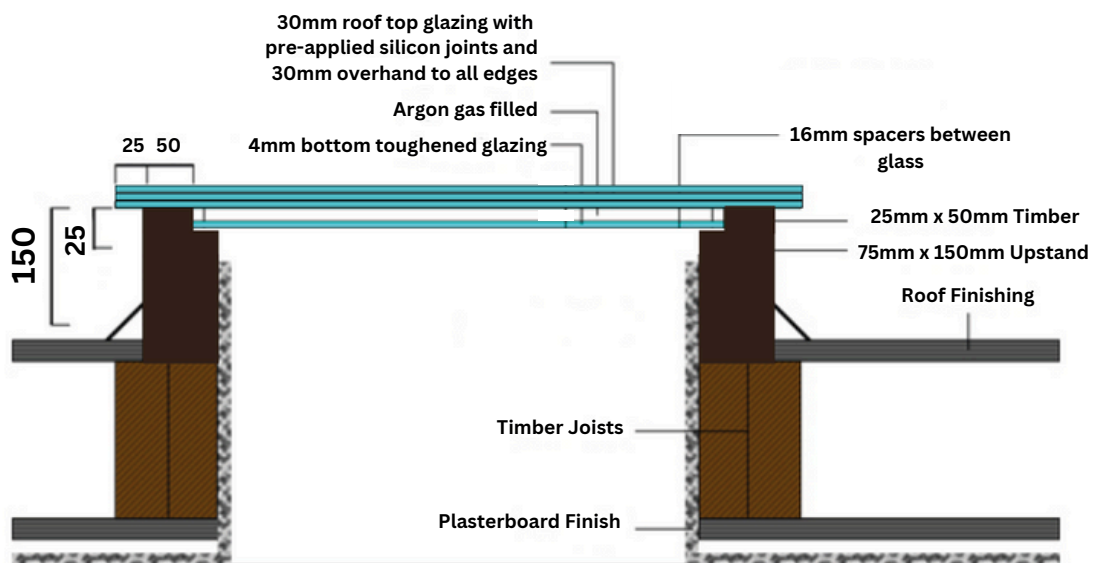

# 1.

Firstly, measure out the area you wish to site your walk on rooflight, ensuring all the internal dimensions are correct with the product you have purchased. Your internal opening will be the same size you have ordered (for example if you have ordered a 400mm x 1800mm, your internal opening needs to be 400mm x 1800mm exact). Please note 150mm is the total measurement including the 25mm High batten.

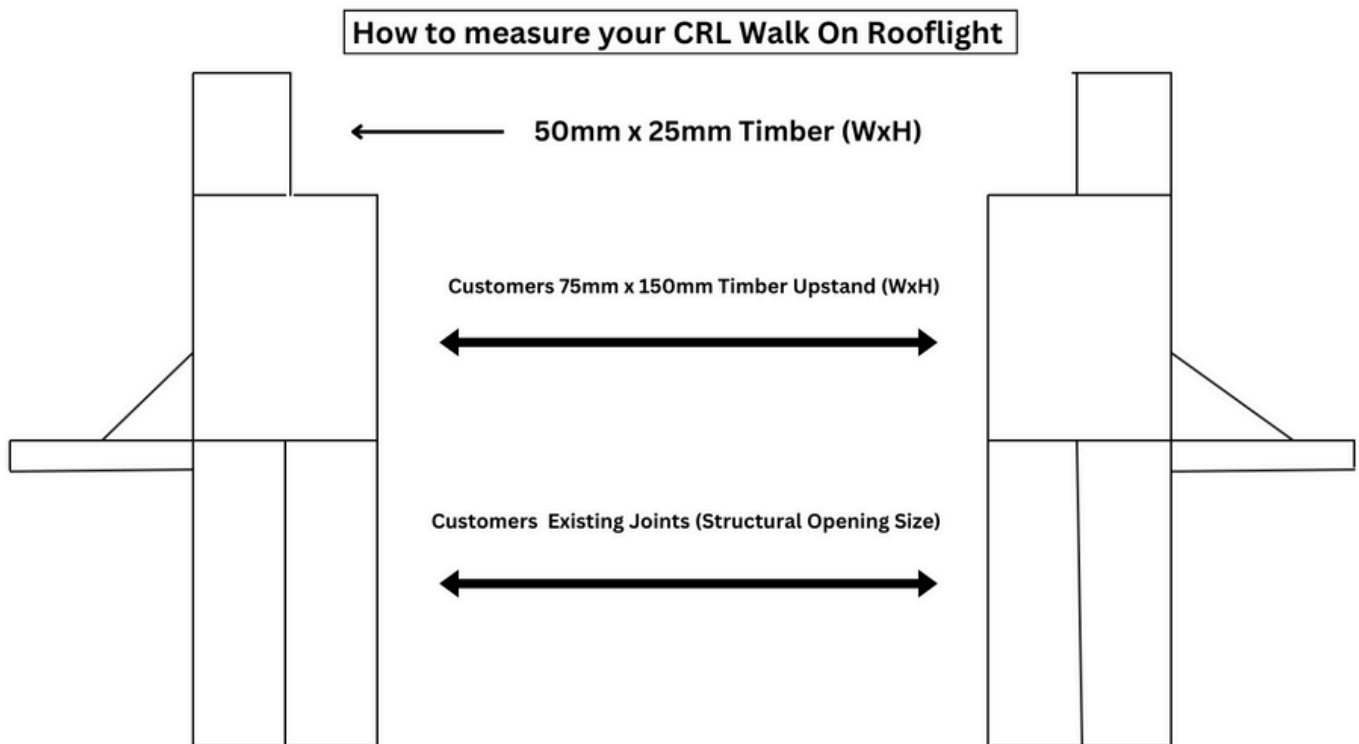

# 2.

Create your timber upstand around the structural opening ensuring the internal face of the upstand are flush with your joist work. Your upstand needs to be 75mm wide and a minimum of 150mm high at the lowest point. (6" X 3")

### 3.

Create your kerb, install a baton on top of your upstand around the outer edge. This baton needs to be 25mm high and 50mm wide.

### 4.

Now proceed to finish your roof covering up to the top of your upstand .

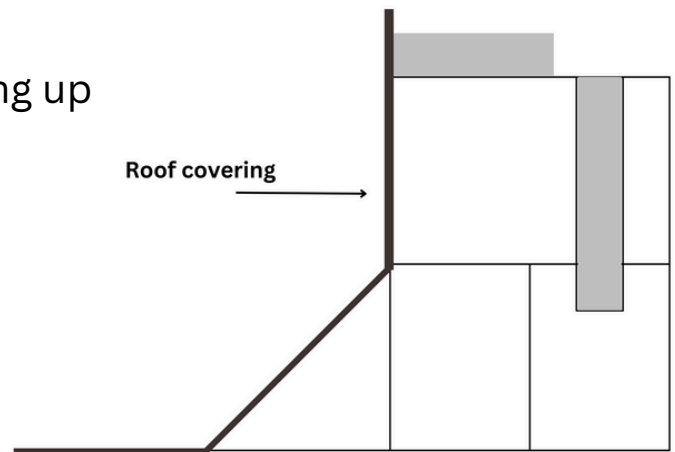

### 5.

Apply DOW791 silicone to both flat surfaces of the kerb and the corner of the rebated glass unit.

Using the wrong silicone can cause failure in the unit and will invalidate your warranty.

**6.**

Position the CRL walk on rooflight glazing into the easy fit frame ensuring the step of the glazing is set inside the rebate of the easy fit kerb.

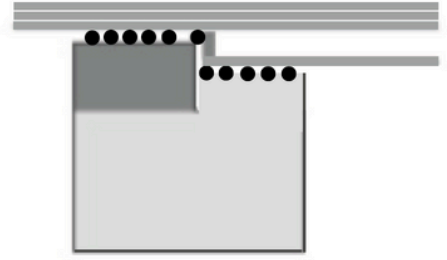

**7.**

Apply pressure on the CRL walk on rooflight glazing to ensure an even work your way around the perimeter of the rooflight. You should now have a impermeable bond between the easy fit kerb and the walk on rooflight glazing.



**8.**

Leave the silicone to cure and then clean any excess off with a blade or scraper being careful not to scratch or mark your walk on rooflight glazing.



**01202 802111**  
**www.crlonline.co**